

# 2B

**LARGE BALCONY** 126 SQM (Net)

The 2B master bedroom includes an en suite bathroom and a south-facing balcony. Homeowners can maximize this condo's generous layout with the built-in closets by the entrance and bedrooms.



126 SQM  
NET



**Net SQM Calculation** Net calculation is based on the perimeter red line as indicated.  
**Room Areas** Measurements for rooms are approximate only and calculated based on expected usable space, excluding walls and extrusions. Room spaces will total less than the total NET space. Please refer to dimensions or drawings provided for the unit with the SPA.

**Variance** These drawings represent conceptual layout before final engineering stage and are subject to change based on regulatory or technical requirements.

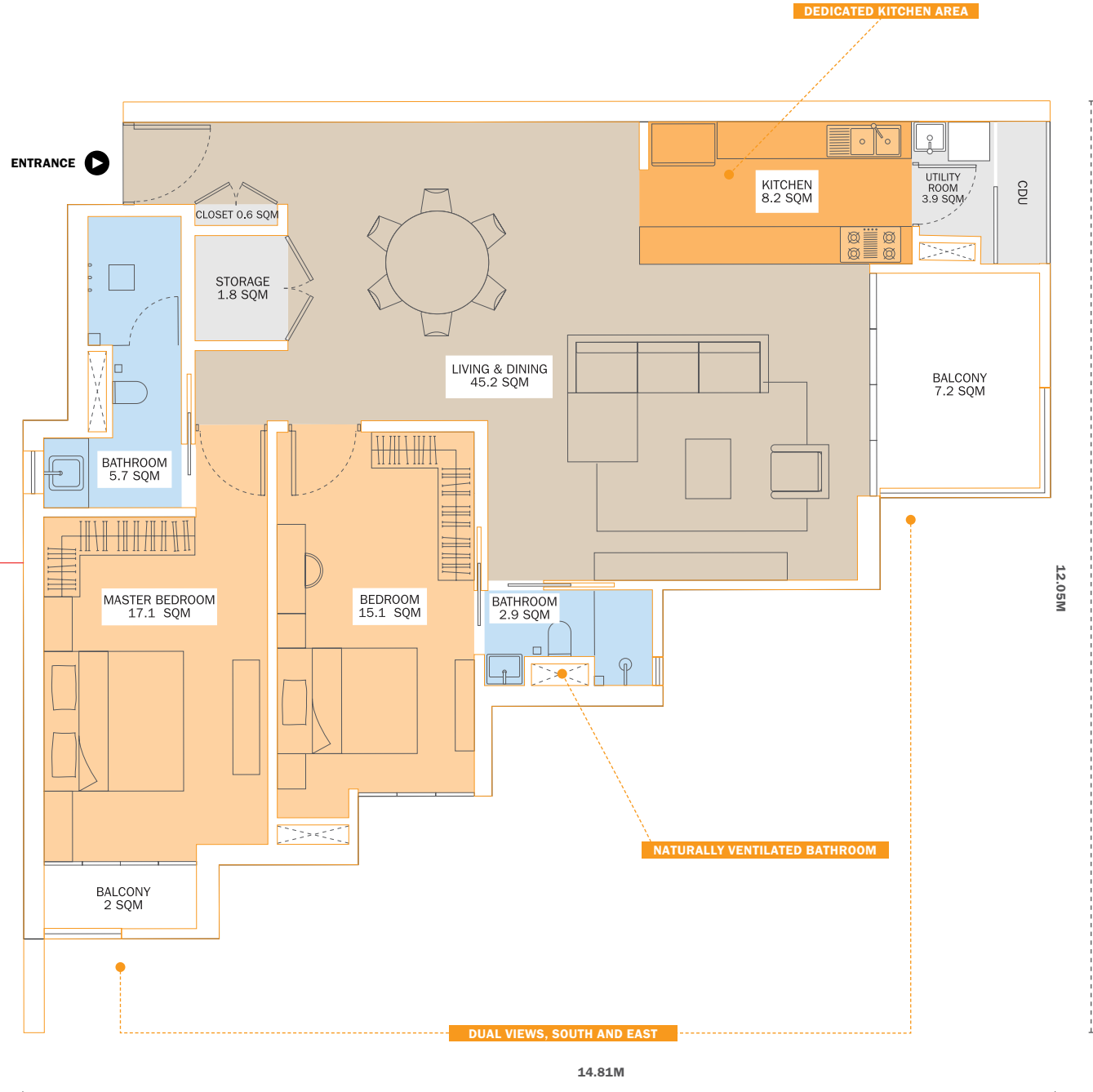

14.81M

# 2B

## LARGE BALCONY 126 SQM (Net)

The southeast views of our 2B homes receive light throughout the day with less heat. This means you get to enjoy unforgettable sunrises and views towards the Mekong at pleasant temperatures.

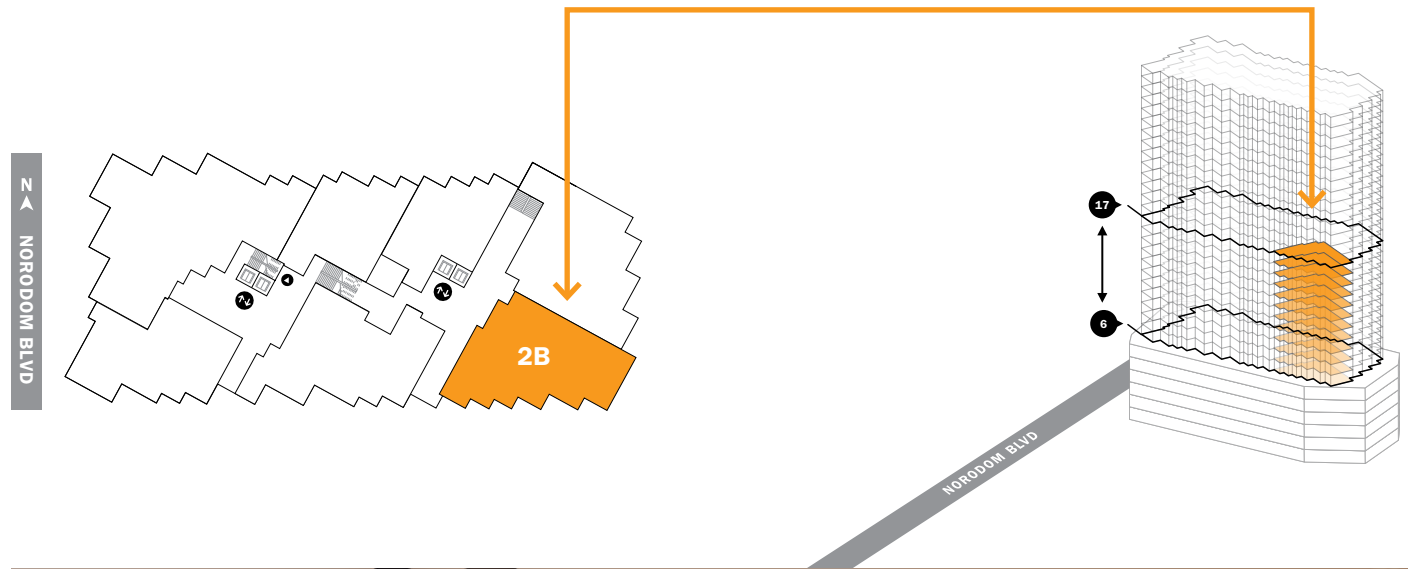

## AMENITIES

### EQUIPPED KITCHEN\*

- 4-plate electric stove
- Electric hood
- Oven
- High-quality sink

\*Refrigerator not included

### DESIGN-FOCUSED BATHROOMS

- Glass-doored shower
- Sink
- Vanity
- Toilet
- Naturally ventilated bathroom
- 2 showers, 2 toilets, 2 basins

### COMFORTS THROUGHOUT THE HOME

- Living room balcony
- En suite bedroom balcony
- Large windows
- Energy-efficient AC units in living areas and bedrooms
- Parquet flooring in bedrooms, Living and Dining areas
- Beautifully tiled floors in Kitchen areas
- Ceiling fans



ARCHITECT'S RENDER OF THE SPACIOUS MASTER BEDROOM